

## Unit type C (1 bedroom – person with a disability)

### FLOOR PLAN

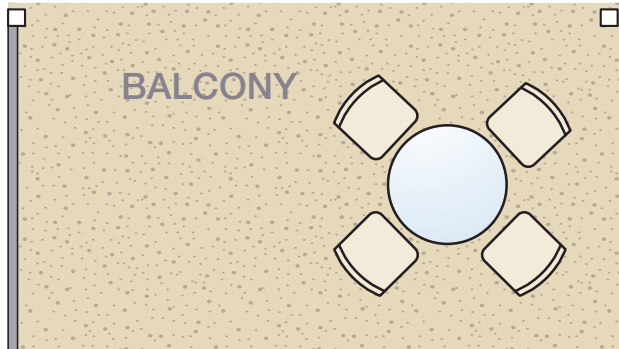

Total area 43m<sup>2</sup>  
Excludes balcony. Measured to inside face of walls.

Living/Dining Area	15.2m <sup>2</sup>	4.6m x 3.3m
Kitchen	7.1m <sup>2</sup>	3.3m x 2.1m
Bedroom	12.7m <sup>2</sup>	3.9m x 3.1m
Balcony	8.5m <sup>2</sup>	3.7m x 2.3m

Notes: Bedroom areas & sizes include robes.  
Furniture shown is for display purposes only.

Measurements are approximate.  
Sizes and layouts may vary.

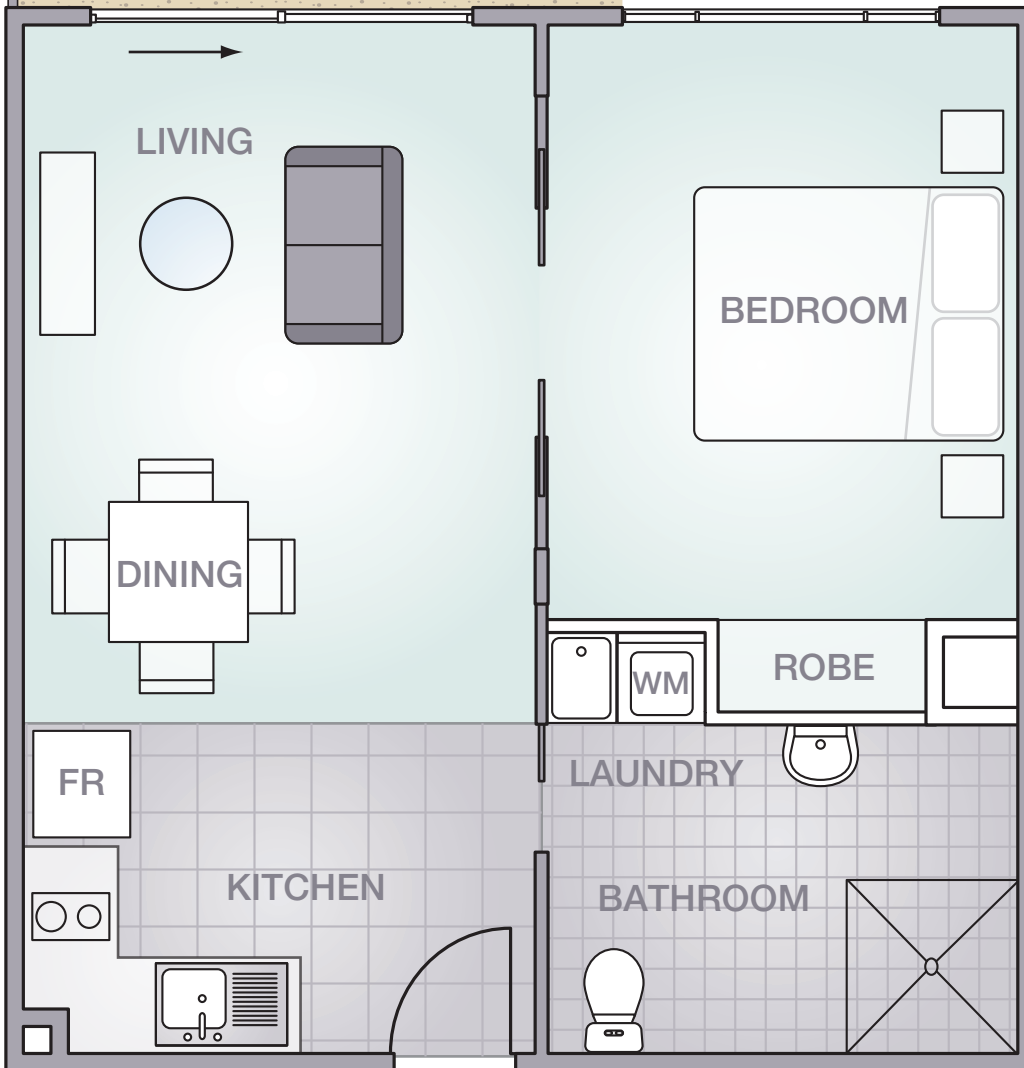

ENTRY

